

## 11. Fuel Injector

### A: REMOVAL

#### 1. RH SIDE

- 1) Disconnect the ground cable from battery.
- 2) Remove the intake manifold. <Ref. to FU(STI)-17, REMOVAL, Intake Manifold.>
- 3) Remove clip (A) holding the engine harness to the fuel pipe protector RH, and remove the fuel pipe protector RH from the intake manifold.

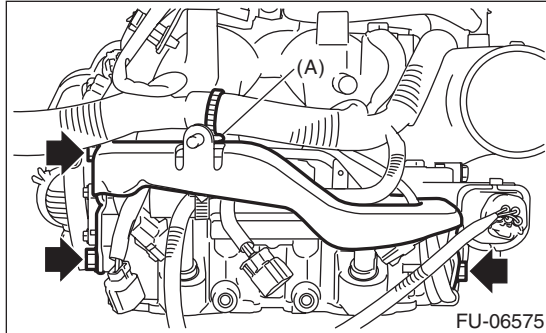

- 4) Remove the harness band (A) which holds the engine harness to the fuel injector pipe RH.

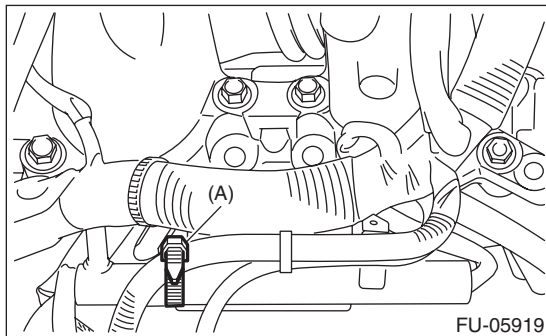

- 5) Disconnect the connector from fuel injector.

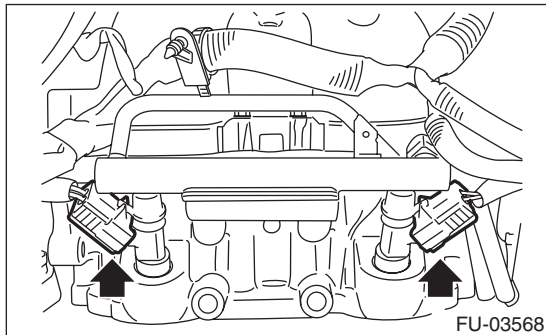

- 6) Remove the bolts which hold fuel injector pipe RH.

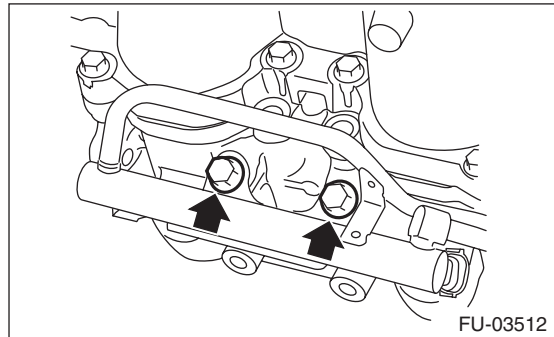

- 7) Remove the fuel injector.

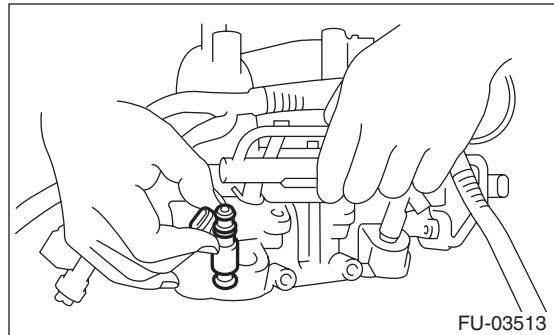

#### 2. LH SIDE

- 1) Disconnect the ground cable from battery.
- 2) Remove the intake manifold. <Ref. to FU(STI)-17, REMOVAL, Intake Manifold.>
- 3) Remove the fuel pipe protector LH from the intake manifold.

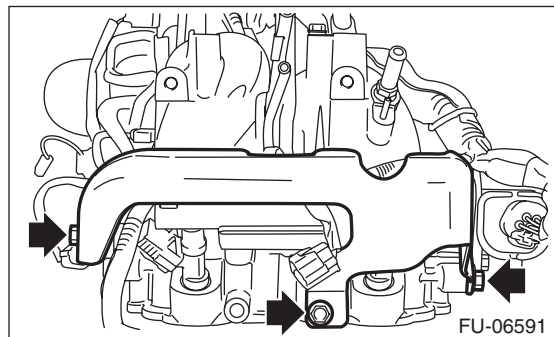

- 4) Remove the harness band (A) which holds the engine harness to the fuel injector pipe LH.

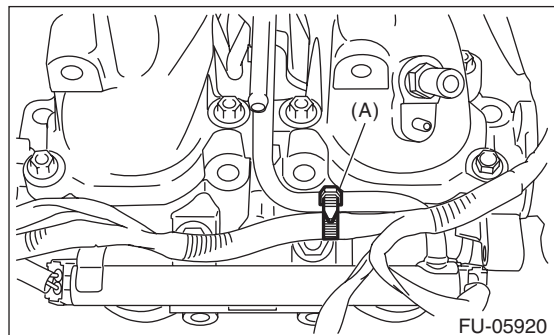

# Fuel Injector

## FUEL INJECTION (FUEL SYSTEMS)

5) Disconnect the connector from fuel injector.

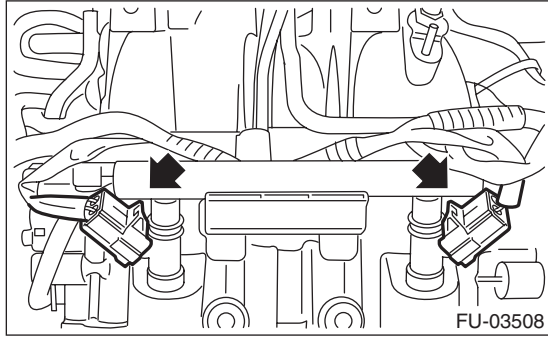

6) Remove the bolts which hold fuel injector pipe LH.

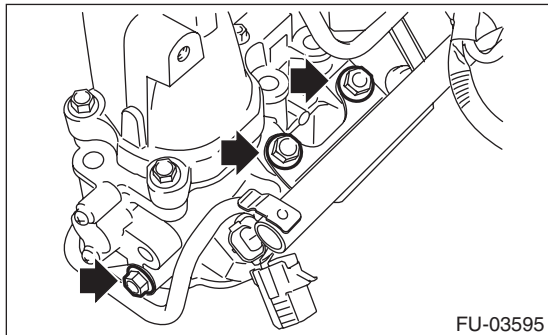
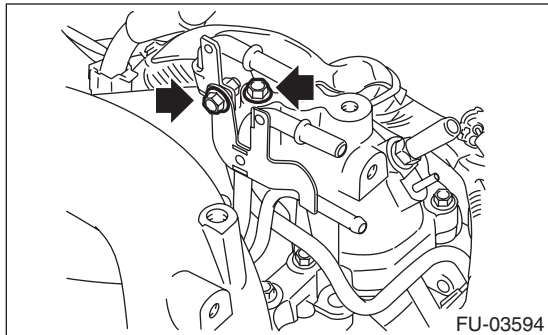

7) Remove the fuel injector.

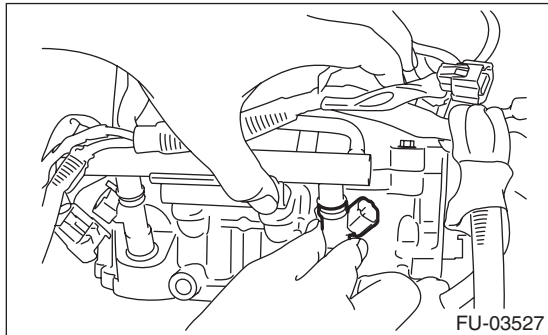

## B: INSTALLATION

### 1. RH SIDE

Install in the reverse order of removal.

NOTE:

Use new O-rings, rubbers and seal rings.

**Tightening torque:**

**19 N·m (1.9 kgf-m, 14.0 ft-lb)**

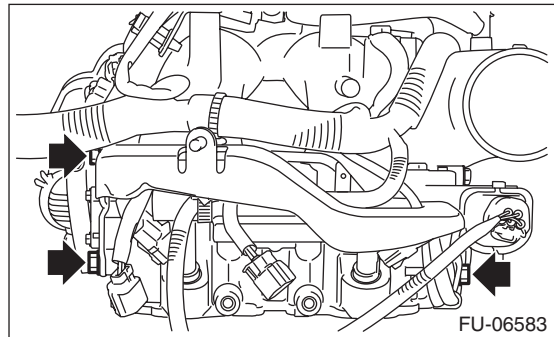
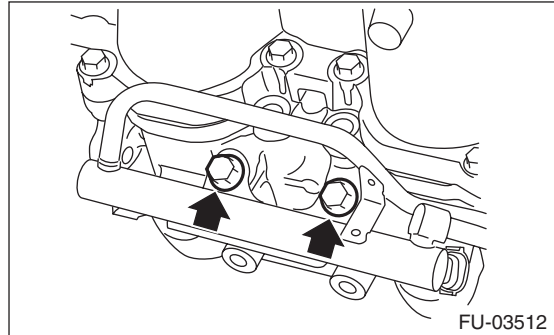

2. LH SIDE

Install in the reverse order of removal.

NOTE:

Use new O-rings, rubbers and seal rings.

**Tightening torque:**

**6.4 N·m (0.7 kgf-m, 4.7 ft-lb)**

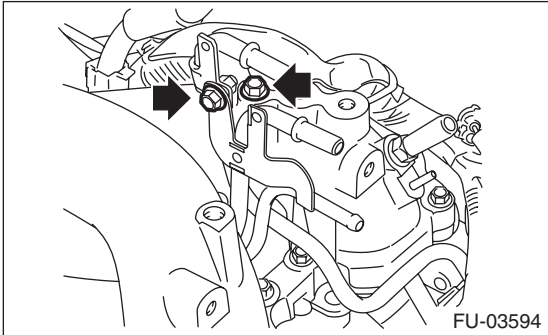

**Tightening torque:**

**19 N·m (1.9 kgf-m, 14.0 ft-lb)**

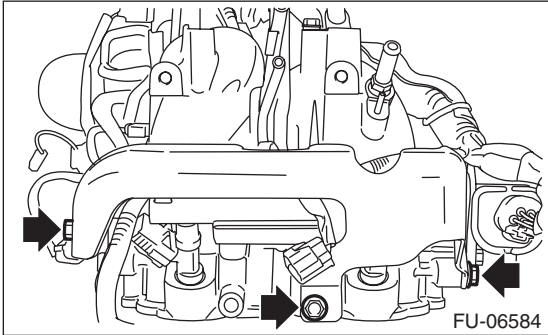
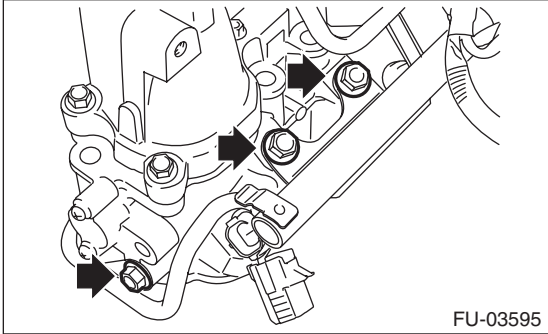

C: INSPECTION

- 1) Check that the fuel injector has no deformation, cracks or other damages.
- 2) Measure the resistance between fuel injector terminals.

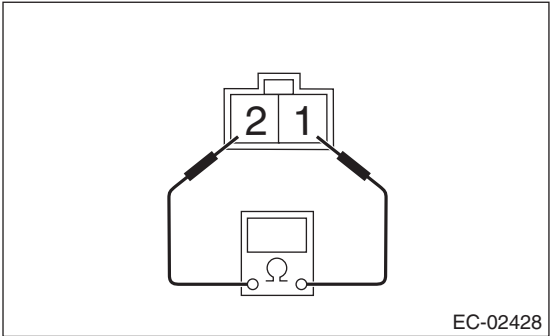

Terminal No.	Standard
1 and 2	Approx. 12.0 Ω (when 20°C (68°F))